

PLUG: WRDV 122 PD9 JL  
 RECEPTACLE: WRD 122 SAD9 JTA  
 XXXX XXX XXXX XXX

**PLUG**

**RECEPTACLE**

**SERIES**

WRDV Plug, straight, without mounting ears	WRD Receptacle, straight, without mounting ears
	WRD Receptacle, right angle, without mounting ears

**SIZE**

122 Number of contacts	122 Number of contacts
------------------------	------------------------

**CONTACTS**

- Pin or socket contacts can be used in either plug or receptacle.
  - When pin contacts are used, standard hardware orientation places the female hardware next to the #1 pin contact.
  - When socket contacts are used, standard hardware orientation places the male hardware next to the #1 socket contact.
- |  |  |
|--|--|
| <p><b>TYPE CONTACTS/TERMINATIONS:</b></p> <p>PC Pin, straight, solder cup (.035" I.D.)</p> <p>PD7 Pin, straight, dip solder, .109" x .027" dia</p> <p>PD9 Pin, straight, dip solder, .140" x .027" dia</p> <p>PD11 Pin, straight, dip solder, .172" x .027" dia</p> <p>PD15 Pin, straight, dip solder, .234" x .027" dia</p> | <p><b>TYPE CONTACTS/TERMINATIONS:</b></p> <p>SAC Socket, straight, solder cup (.035" I.D.)</p> <p>SAD7 Socket, straight, dip solder, .109" x .027" dia</p> <p>SAD9 Socket, straight, dip solder, .140" x .027" dia</p> <p>SAD11 Socket, straight, dip solder, .172" x .027" dia</p> <p>SAD15 Socket, straight, dip solder, .234" x .027" dia</p> <p>SAF3 Socket, straight, flex circuit, .050"</p> <p>SAF6 Socket, straight, flex circuit, .093"</p> <p>SAG7 Socket, straight, dip solder, .109" x .018" dia</p> <p>SAG9 Socket, straight, dip solder, .140" x .018" dia</p> <p>SAG11 Socket, straight, dip solder, .172" x .018" dia</p> <p>SAP Socket, straight, pin termination .150", connector saver</p> <p>SOR9 Socket, right angle, dip solder, .140" x .025" dia</p> |
|--|--|

**HARDWARE**

- |  |  |
|--|--|
| <p>J Fixed jackset</p> <p>JL Fixed jackset, long</p> <p>JTA Turning jackset, .160"</p> <p>JTB Hex turning jackset, .160"</p> <p>JTL Long turning jackset, .660"</p> <p>SY Guide set</p> <p>SY-# Guide set, polarized</p> | <p>J Fixed jackset</p> <p>JL Fixed jackset, long</p> <p>JTA Turning jackset, .160"</p> <p>JTB Hex turning jackset, .160"</p> <p>JTL Long turning jackset, .660"</p> <p>SY Guide set</p> <p>SY-# Guide set, polarized</p> |
|--|--|

**OPTIONS**

- Option Codes: Add to the end of the part number. Example: WRD122SAD9SY-D01. Call factory for additional codes.
  - B82 Termination face sealed against conformal coating
  - D01 Pretinned contact terminations (except solder cups, wire wraps<sup>®</sup> and flex contacts) with 63/37 or 60/40 solder.
  - P39 Pretinned contact terminations (except solder cups, wire wraps<sup>®</sup> and flex contacts) with SAC305 solder (lead free).
  - D54 Combine -B82 & -D01 special codes
- = Option not RoHS compliant

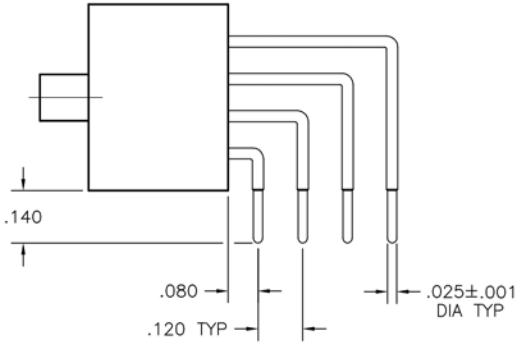

EXAMPLE: WRD122SOR9J